

PANOLA COUNTY SHERIFF'S OFFICE

Office: 903.693.0333
Fax: 903.693.9366

314 W. Wellington
Carthage, Texas 75633



Sheriff Kevin Lake

July 17, 2018

The Honorable LeeAnn Jones
Panola County Judge
110 S. Sycamore
Carthage, Texas 75633

Dear Judge Jones,

Please add the following items to the next scheduled meeting of the Panola County Commissioner's Court:

Please record the employment of Dalton Tanner as a Detention Officer for the Panola County Sheriff's Office at a pay rate of \$13.91 per hour effective July 21, 2018.

Sincerely,

A handwritten signature in black ink, appearing to read "K. Lake".

Kevin Lake
Sheriff

KL/lw

CC: Sidney Burns
Joni Reed

Honesty, Integrity, Service

**NOTICE OF PROPOSED INSTALLATION
PIPELINE AND/OR UTILITY LINES**

TO: THE PANOLA COUNTY COMMISSIONER'S COURT

c/o

PANOLA COUNTY ROAD & BRIDGE DEPARTMENT, CARTHAGE, TEXAS

Formal notice is hereby given that:

Rock Hill Water Supply Corporation proposes to place a
(COMPANY NAME)

2" line within the Right-of-Way
(PIPE SIZE)

of County Road: 306 as follows:
(NUMBER OF ROAD)

The proposed pipeline will cross under the indicated roads on the attached sheet.
Installation shall be made by boring a total length of 700' line in Panola County.

The location and description of the proposed line and appurtenances is more fully shown by the copies of the drawings attached to this notice. The line will be constructed and maintained on the County Right-of-Way as directed by the County Commissioners in accordance with current Panola County Specifications.

Construction of this line will begin on or after the 9th day of
July, 2018.

FIRM: Rock Hill Water Supply Coporation
BY: Wade Allums
TITLE: Operator/Manager
ADDRESS: 220 County Road 212
Beckville, Texas 75631
PHONE: (903) 678-9073

APPROVAL

July 24, 2018

TO: RockHill Water Supply Corporation
Attn: Wade Allums
220 County Road 212
Beckville, Texas 75631

RE: **CR #306**

The Panola County Commissioners' Court offers no objection to the location on the right-of-way of your proposed **2" line** within the right-of-way of County Roads **#306** as shown by accompanying drawings and notice except as noted below.

It is expressly understood that the County Commissioners' Court does not purpose hereby, to grant any right, claim, title or easement in or upon this county road. It is further understood that in the future should for any reason the county need to work, improve, relocate, widen, increase, add to, or in any manner change the structure of this right-of-way, any required relocation of said lines shall be at the sole expense of owner.

All work on the county right-of-way shall be performed in accordance with the county instructions. The installations shall not damage any part of the road and adequate provisions must be made to cause minimum inconvenience to traffic and adjacent owners. Special specifications for placing this line are as follows:

1. All lines are to be installed a minimum of 36 inches below the flow line of the adjacent drainage or barrow ditch.
2. All excavation within the right-of-way and not under surfacing shall be backfilled by tamping in 6 inch horizontal layers. All surplus material shall be removed from the right-of-way and the excavation finished flush with surrounding natural ground.
3. Lines crossing under surfaced roads and under surfacing cross roads within the right-of-way shall be placed by boring. Boring shall extend from crown line to crown line. Gravity from sewer lines under roadways shall be cast iron pipe.
4. All lines, where practicable, shall be located to cross roadbed at approximately right angles thereto. No lines are to be installed under or within 50 feet of either end of any bridge. No lines shall be placed in any culvert or within 10 feet of the closest point of same.
5. Parallel line will be installed as near the right-of-way lines as is possible and

no parallel line will be installed in the roadbed or between the drainage ditch and the roadbed without special permission of the Panola County Commissioners' Court.

6. Operations along roadbeds shall be performed in such manner that all excavated material be kept off the pavement at all times, as well as all operating equipment and materials. No equipment or installation procedures will be used which will damage any road surface or structures. The cost of any repairs to road surface, roadbed, structures or other right-of-way features as a direct result of this installation will be borne by the owner of this line.
7. Barricades, warning signs, lights, and flag man(men) when necessary shall be provided by the contractor or owner. One-half (1/2) of the traveled portion of the road must be open at all times.

Approved: 
COUNTY JUDGE

COMMISSIONERS:

Precinct #1	Ronnie LaGrone
Precinct #2	John Gradberg
Precinct #3	Craig M. Lawless
Precinct #4	Dale LaGrone

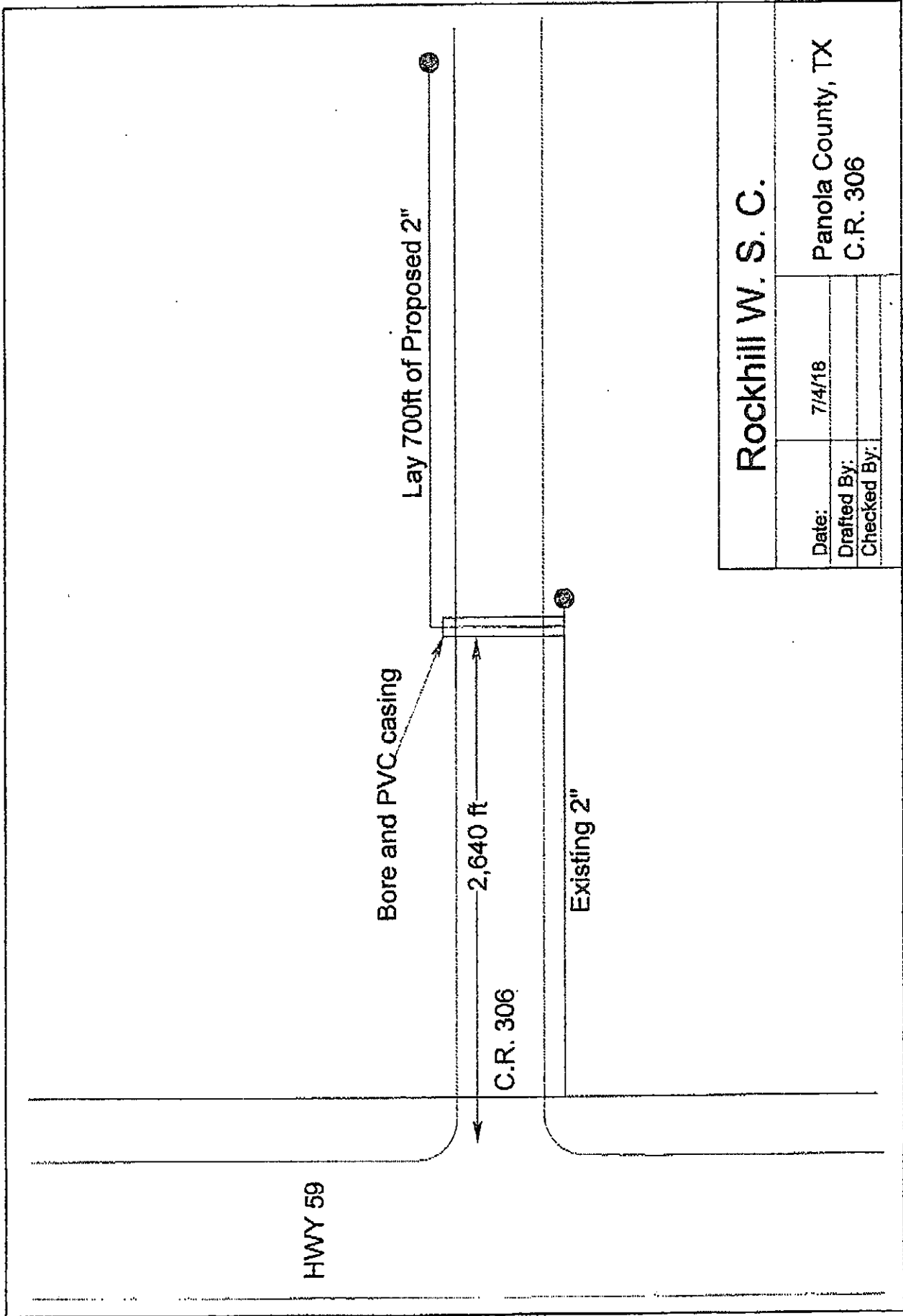

Rockhill W. S. C.			
Date:	7/4/18	Panola County, TX	
Drafted By:		C.R. 306	
Checked By:			

NOTICE OF PROPOSED INSTALLATION
PIPELINE AND/OR UTILITY LINES

TO: THE PANOLA COUNTY COMMISSIONER'S COURT

c/o

PANOLA COUNTY ROAD & BRIDGE DEPARTMENT, CARTHAGE, TEXAS

Formal notice is hereby given that:

Branch Midstream Company, LLC proposes to place a
(COMPANY NAME)

12" Gas & 3.5" Water line within the Right-of-Way
(PIPE SIZE)

of County Road: 328 as follows:
(NUMBER OF ROAD)

The proposed pipeline will cross under the indicated roads on the attached sheet.
Installation shall be made by boring a total length of 30 ft line in Panola County.

The location and description of the proposed line and appurtenances is more fully shown by the copies of the drawings attached to this notice. The line will be constructed and maintained on the County Right-of-Way as directed by the County Commissioners in accordance with current Panola County Specifications.

Construction of this line will begin on or after the 1st day of
October, 2018.

FIRM: Cypress Energy Corp.
BY: Justin Smith
TITLE: SR. ROW Agent
ADDRESS: 400 Travis St, Ste 1909
Spert, LA 71101
PHONE: (818) 294-6875

APPROVAL

July 24, 2018

TO: Branch Midstream Company, LLC
Attn: Justin Smith @ Cypress Energy Corp.
400 Travis Street, Ste 1909
Shreveport, Louisiana 71101

RE: **CR #328**

The Panola County Commissioners' Court offers no objection to the location on the right-of-way of your proposed **12" Gas line & 3.5" Water line** within the right-of-way of County Roads **#328** as shown by accompanying drawings and notice except as noted below.

It is expressly understood that the County Commissioners' Court does not purpose hereby, to grant any right, claim, title or easement in or upon this county road. It is further understood that in the future should for any reason the county need to work, improve, relocate, widen, increase, add to, or in any manner change the structure of this right-of-way, any required relocation of said lines shall be at the sole expense of owner.

All work on the county right-of-way shall be performed in accordance with the county instructions. The installations shall not damage any part of the road and adequate provisions must be made to cause minimum inconvenience to traffic and adjacent owners. Special specifications for placing this line are as follows:

1. All lines are to be installed a minimum of 36 inches below the flow line of the adjacent drainage or barrow ditch.
2. All excavation within the right-of-way and not under surfacing shall be backfilled by tamping in 6 inch horizontal layers. All surplus material shall be removed from the right-of-way and the excavation finished flush with surrounding natural ground.
3. Lines crossing under surfaced roads and under surfacing cross roads within the right-of-way shall be placed by boring. Boring shall extend from crown line to crown line. Gravity from sewer lines under roadways shall be cast iron pipe.
4. All lines, where practicable, shall be located to cross roadbed at approximately right angles thereto. No lines are to be installed under or within 50 feet of either end of any bridge. No lines shall be placed in any culvert or within 10 feet of the closest point of same.

5. Parallel line will be installed as near the right-of-way lines as is possible and no parallel line will be installed in the roadbed or between the drainage ditch and the roadbed without special permission of the Panola County Commissioners' Court.
6. Operations along roadbeds shall be performed in such manner that all excavated material be kept off the pavement at all times, as well as all operating equipment and materials. No equipment or installation procedures will be used which will damage any road surface or structures. The cost of any repairs to road surface, roadbed, structures or other right-of-way features as a direct result of this installation will be borne by the owner of this line.
7. Barricades, warning signs, lights, and flag man(men) when necessary shall be provided by the contractor or owner. One-half (1/2) of the traveled portion of the road must be open at all times.

Approved: 
COUNTY JUDGE

COMMISSIONERS:

Precinct #1	Ronnie LaGrone
Precinct #2	John Gradberg
Precinct #3	Craig M. Lawless
Precinct #4	Dale LaGrone

Legend



Apollo Line

Branch Midstream Lin

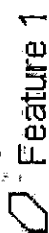

Feature 1

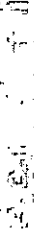

Header Opt.H

CR 328 Road Crossing

328

800 ft



NOTICE OF PROPOSED INSTALLATION
PIPE AND / OR UTILITY LINES

DATE 6 - 22 - 18

TO : THE PANOLA COUNTY COMMISSIONERS COURT

c / o

PANOLA COUNTY ROAD & BRIDGE DEPARTMENT CARTHAGE TEXAS

Formal notice is hereby given that :

Eastex Telephone Co-op proposes to place a
(COMPANY NAME)

1 ½" DUCT with cable line within the Right-of-way
(PIPE SIZE)

of County Road : 337 as follows :
(NUMBER OF ROAD)

The proposed line will parallel the indicated roads on the attached sheet.
Installation shall be made by boring total length of line in Panola County is 1640'.

From the intersection of CR 328 and CR 337 travel west on CR 337 approximately 3600' to where work will begin on south side of CR 337. Boring and installing cable from existing telephone box and going west on south side of CR 337 for approx. 1640'.

The location and description of the proposed line and appurtenances is more fully shown by the copies of drawings attached to this notice. The line will be constructed and maintained on the County Right-of-Way as directed by the County Commissioners in accordance with current Panola County Specifications.

Construction of this line will begin on or after the

9th day of July, 2018

FIRM : EASTEX TELEPHONE CO-OP

BY : 

TITLE : STAKING REPRESENTATIVE

ADDRESS : P. O. BOX 1691

WASKOM, TEXAS 75692

PHONE : (903) 687-3600

APPROVAL

July 24, 2018

TO: Eastex Telephone Co-op
Attn: Larry Goswick
P.O. Box 1691
Waskom, Texas 75692

RE: **CR #337**

The Panola County Commissioners' Court offers no objection to the location on the right-of-way of your proposed **1 ½" duct with cable line** within the right-of-way of County Roads **#337** as shown by accompanying drawings and notice except as noted below.

It is expressly understood that the County Commissioners' Court does not purpose hereby, to grant any right, claim, title or easement in or upon this county road. It is further understood that in the future should for any reason the county need to work, improve, relocate, widen, increase, add to, or in any manner change the structure of this right-of-way, any required relocation of said lines shall be at the sole expense of owner.

All work on the county right-of-way shall be performed in accordance with the county instructions. The installations shall not damage any part of the road and adequate provisions must be made to cause minimum inconvenience to traffic and adjacent owners. Special specifications for placing this line are as follows:

1. All lines are to be installed a minimum of 36 inches below the flow line of the adjacent drainage or barrow ditch.
2. All excavation within the right-of-way and not under surfacing shall be backfilled by tamping in 6 inch horizontal layers. All surplus material shall be removed from the right-of-way and the excavation finished flush with surrounding natural ground.
3. Lines crossing under surfaced roads and under surfacing cross roads within the right-of-way shall be placed by boring. Boring shall extend from crown line to crown line. Gravity from sewer lines under roadways shall be cast iron pipe.
4. All lines, where practicable, shall be located to cross roadbed at approximately right angles thereto. No lines are to be installed under or within 50 feet of either end of any bridge. No lines shall be placed in any culvert or within 10 feet of the closest point of same.
5. Parallel line will be installed as near the right-of-way lines as is possible and

no parallel line will be installed in the roadbed or between the drainage ditch and the roadbed without special permission of the Panola County Commissioners' Court.

6. Operations along roadbeds shall be performed in such manner that all excavated material be kept off the pavement at all times, as well as all operating equipment and materials. No equipment or installation procedures will be used which will damage any road surface or structures. The cost of any repairs to road surface, roadbed, structures or other right-of-way features as a direct result of this installation will be borne by the owner of this line.
7. Barricades, warning signs, lights, and flag man(men) when necessary shall be provided by the contractor or owner. One-half (1/2) of the traveled portion of the road must be open at all times.

Approved: 
COUNTY JUDGE

COMMISSIONERS:

Precinct #1	Ronnie LaGrone
Precinct #2	John Gradberg
Precinct #3	Craig M. Lawless
Precinct #4	Dale LaGrone

Texas, United States, North America

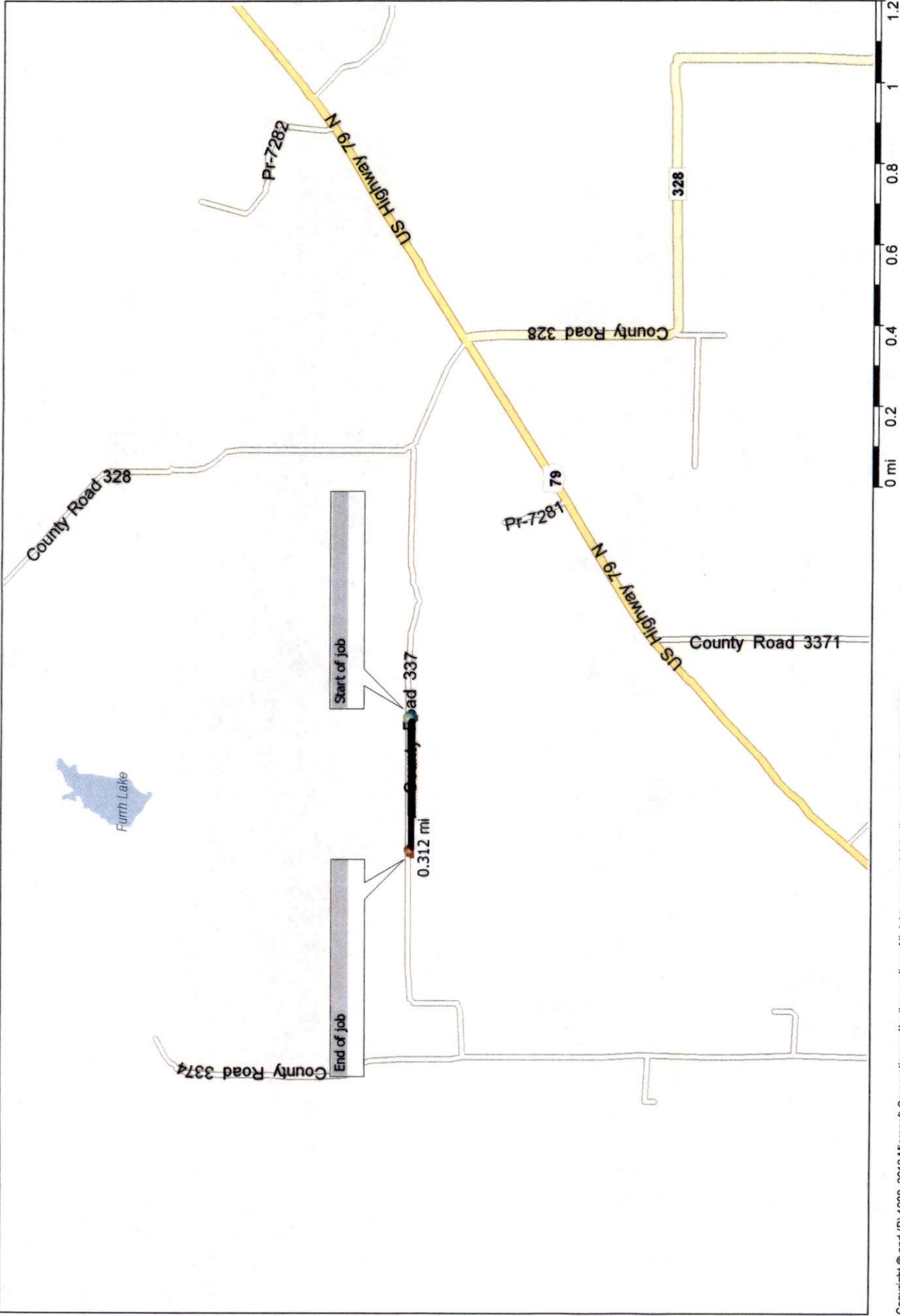

INST APPROX 626' OF BFC25-24
 INST APPROX 596' OF BM60-1-1/2"
 ONE BD-3 PED

W/O 18-06-1319
 FOR BFC 25-24
 AND (2) BD-3 PEDS

13
 DB1-57
 BD.3

626'
 BFC25-24
 596'

12
 DB1-57
 BD.3

CR 337

CR 337

CO

B

PED ID	HH ID	POLE ID	BD EX	BD	BD	BFC	BFC	BFC	BFO	HH EX	HH PN	HH PN	SINGLE MICRO 14/10	BM-60 1.25"	BM-60 1.50"	4-WAY MICRO DUCT	7-WAY MICRO DUCT	FIBER POST WGRD	FIBER POST	FIBER PROT 1803	BFO DROP	COPPER PROT 1406	SEBP 6-22	GRD ROD	#6 BARE	#6 INSUL
1-57/12			EX (3)																							
1-57/13				1			626								596									1	5	
TOTAL	0	0	0	1	1	0	626	0	0	0	0	0	0	0	596	0	0	0	0	0	0	0	0	1	5	0



EXCHANGE DBRY

COUNTY PANOLA

ROUTE

DB1-57

BY: RHONDA N

JOB NO. 18-06-1319

MAP REF.

AS BUILT DATE

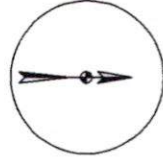

SHEET 1 OF 2

W/O 18-06-1322
FOR SEPB 6X22 DROP

INST APPROX 1076' OF BFC25-24
INST APPROX 1044' OF BM60-1-1 1/2"
ONE BD-3 PED

W/O 18-06-1319
FOR BFC 25-24
AND (2) BD-3 PEDS

342'
SEBP6-22

1076'
BFC25-24

BM60-1 1 1/2"
1044'

14
DB1-57
BD3

[illegible]

EXCHANGE: DERY

COUNTY	PANOLA
--------	--------

ROUTE

00015
000157

BY: RHONDA N.

JOB NO. 18-06-1319 & 1322

MAP REF.

AS BUILT DATE

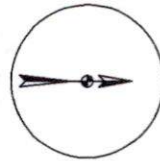

SHEET 2 OF

NOTICE OF PROPOSED INSTALLATION
PIPE AND / OR UTILITY LINES

DATE 7/16/18

TO : THE PANOLA COUNTY COMMISSIONERS COURT

c / o

PANOLA COUNTY ROAD & BRIDGE DEPARTMENT CARTHAGE TEXAS

Formal notice is hereby given that :

Eastex Telephone Co-op proposes to place a
(COMPANY NAME)

BORING INSTALL DUCT & FIBER line within the Right-of-way
(PIPE SIZE)

of County Road : CR 3072 as follows :
(NUMBER OF ROAD)

The proposed pipeline will cross under the indicated roads on the attached sheet.
Installation shall be made by boring total length of line in Panola County is 4,750'.

From the intersection of FM 1794 & CR 3072. Eastex will be boring and installing duct and fiber going south & east & southeast on east & north & east side of CR 3072 for approx. 4,750'.

The location and description of the proposed line and appurtenances is more fully shown by the copies of drawings attached to this notice. The line will be constructed and maintained on the County Right-of-Way as directed by the County Commissioners in accordance with current Panola County Specifications.

Construction of this line will begin on or after the

16th day of JULY, 2018

FIRM : EASTEX TELEPHONE CO-OP

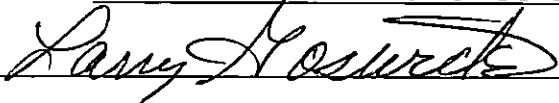
BY : 

TITLE : STAKING REPRESENTATIVE

ADDRESS : P. O. BOX 1691

WASKOM, TEXAS 75692

PHONE : (903) 687-3600

APPROVAL

July 24, 2018

TO: Eastex Telephone Co-op
Attn: Larry Goswick
P.O. Box 1691
Waskom, Texas 75692

RE: **CR #3072, #3073, #3081 & #3082**

The Panola County Commissioners' Court offers no objection to the location on the right-of-way of your proposed **Boring Install Duct & Fiber line** within the right-of-way of County Roads **#3072, #3073, #3081 & #3082** as shown by accompanying drawings and notice except as noted below.

It is expressly understood that the County Commissioners' Court does not purpose hereby, to grant any right, claim, title or easement in or upon this county road. It is further understood that in the future should for any reason the county need to work, improve, relocate, widen, increase, add to, or in any manner change the structure of this right-of-way, any required relocation of said lines shall be at the sole expense of owner.

All work on the county right-of-way shall be performed in accordance with the county instructions. The installations shall not damage any part of the road and adequate provisions must be made to cause minimum inconvenience to traffic and adjacent owners. Special specifications for placing this line are as follows:

1. All lines are to be installed a minimum of 36 inches below the flow line of the adjacent drainage or barrow ditch.
2. All excavation within the right-of-way and not under surfacing shall be backfilled by tamping in 6 inch horizontal layers. All surplus material shall be removed from the right-of-way and the excavation finished flush with surrounding natural ground.
3. Lines crossing under surfaced roads and under surfacing cross roads within the right-of-way shall be placed by boring. Boring shall extend from crown line to crown line. Gravity from sewer lines under roadways shall be cast iron pipe.
4. All lines, where practicable, shall be located to cross roadbed at approximately right angles thereto. No lines are to be installed under or within 50 feet of either end of any bridge. No lines shall be placed in any culvert or within 10 feet of the closest point of same.

5. Parallel line will be installed as near the right-of-way lines as is possible and no parallel line will be installed in the roadbed or between the drainage ditch and the roadbed without special permission of the Panola County Commissioners' Court.
6. Operations along roadbeds shall be performed in such manner that all excavated material be kept off the pavement at all times, as well as all operating equipment and materials. No equipment or installation procedures will be used which will damage any road surface or structures. The cost of any repairs to road surface, roadbed, structures or other right-of-way features as a direct result of this installation will be borne by the owner of this line.
7. Barricades, warning signs, lights, and flag man(men) when necessary shall be provided by the contractor or owner. One-half (1/2) of the traveled portion of the road must be open at all times.

Approved: 
COUNTY JUDGE

COMMISSIONERS:

Precinct #1	Ronnie LaGrone
Precinct #2	John Gradberg
Precinct #3	Craig M. Lawless
Precinct #4	Dale LaGrone

CR 3072 & 3073

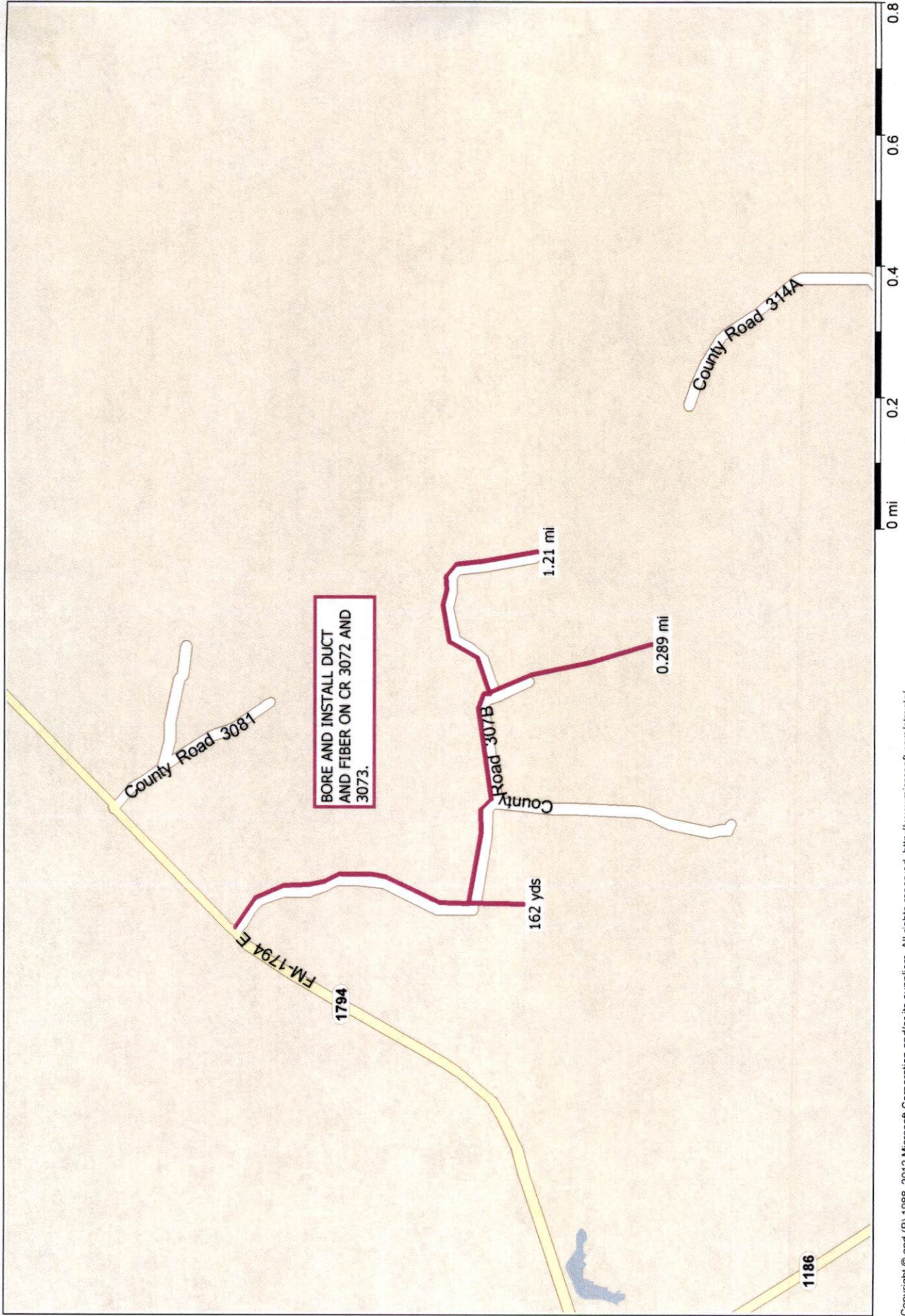

BORE AND INSTALL DUCT
AND FIBER ON CR 3072 AND
3073.

NOTICE OF PROPOSE INSTALLATION
PIPE AND / OR UTILITY LINES

DATE 7/16/18

TO : THE PANOLA COUNTY COMMISSIONERS COURT

c / o

PANOLA COUNTY ROAD & BRIDGE DEPARTMENT CARTHAGE TEXAS

Formal notice is hereby given that :

Eastex Telephone Co-op proposes to place a
(COMPANY NAME)

BORING INSTALL DUCT & FIBER line within the Right-of-way
(PIPE SIZE)

of County Road : CR 3073 as follows :
(NUMBER OF ROAD)

The proposed pipeline will cross under the indicated roads on the attached sheet.
Installation shall be made by boring total length of line in Panola County is 1,500'.

From the intersection of CR 3072 & CR 3073. Eastex will be boring and installing duct and fiber going south on east side of CR 3073 for approx. 1,500'.

The location and description of the proposed line and appurtenances is more full shown by the copies of drawings attached to this notice. The line will be constructed and maintained on the County Right-of-Way as directed by the County Commissioners in accordance with current Panola County Specifications.

Construction of this line will begin on or after the

16th day of JULY, 2018

FIRM : EASTEX TELEPHONE CO-OP

BY : 

TITLE : STAKING REPRESENTATIVE

ADDRESS : P. O. BOX 1691

WASKOM, TEXAS 75692

PHONE : (903) 687-3600

CR 3072 & 3073

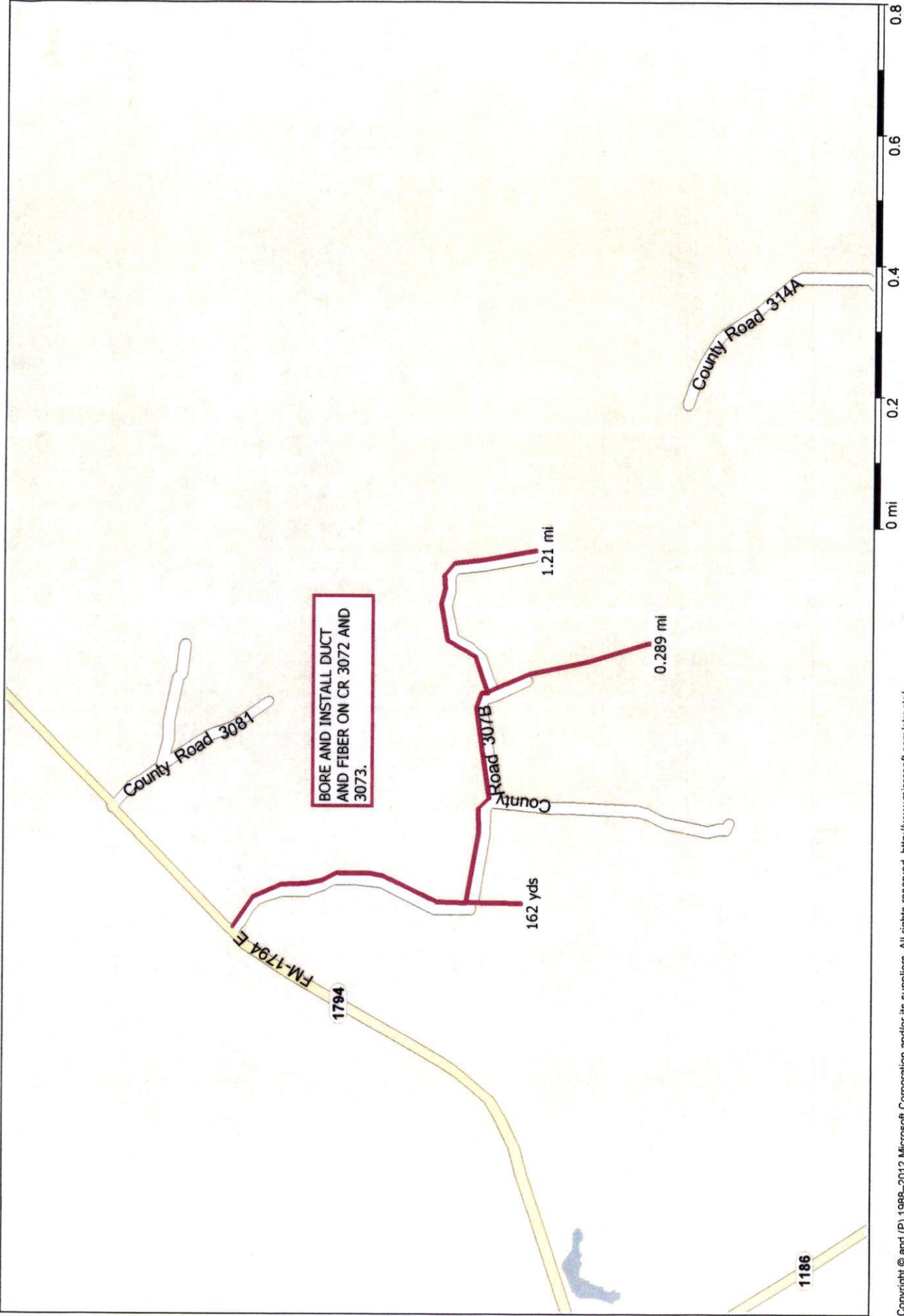

BORE AND INSTALL DUCT
AND FIBER ON CR 3072 AND
3073.

[illegible]

NOTICE OF PROPOSE INSTALLATION
PIPE AND / OR UTILITY LINES

DATE 7/16/18

TO : THE PANOLA COUNTY COMMISSIONERS COURT

c / o

PANOLA COUNTY ROAD & BRIDGE DEPARTMENT CARTHAGE TEXAS

Formal notice is hereby given that :

Eastex Telephone Co-op proposes to place a
(COMPANY NAME)

BORING INSTALL DUCT & FIBER line within the Right-of-way
(PIPE SIZE)

of County Road : CR 3081 as follows :
(NUMBER OF ROAD)

The proposed pipeline will cross under the indicated roads on the attached sheet.
Installation shall be made by boring total length of line in Panola County is 1,700'.

From the intersection of FM 1794 & CR 3081. Eastex will be boring and installing duct and fiber going south on east side of CR 3081 for approx. 1,700'.

The location and description of the proposed line and appurtenances is more full shown by the copies of drawings attached to this notice. The line will be constructed and maintained on the County Right-of-Way as directed by the County Commissioners in accordance with current Panola County Specifications.

Construction of this line will begin on or after the

16th day of JULY, 2018

FIRM : EASTEX TELEPHONE CO-OP

BY : 

TITLE : STAKING REPRESENTATIVE

ADDRESS : P. O. BOX 1691

WASKOM, TEXAS 75692

PHONE : (903) 687-3600

CR 3081 & 3082

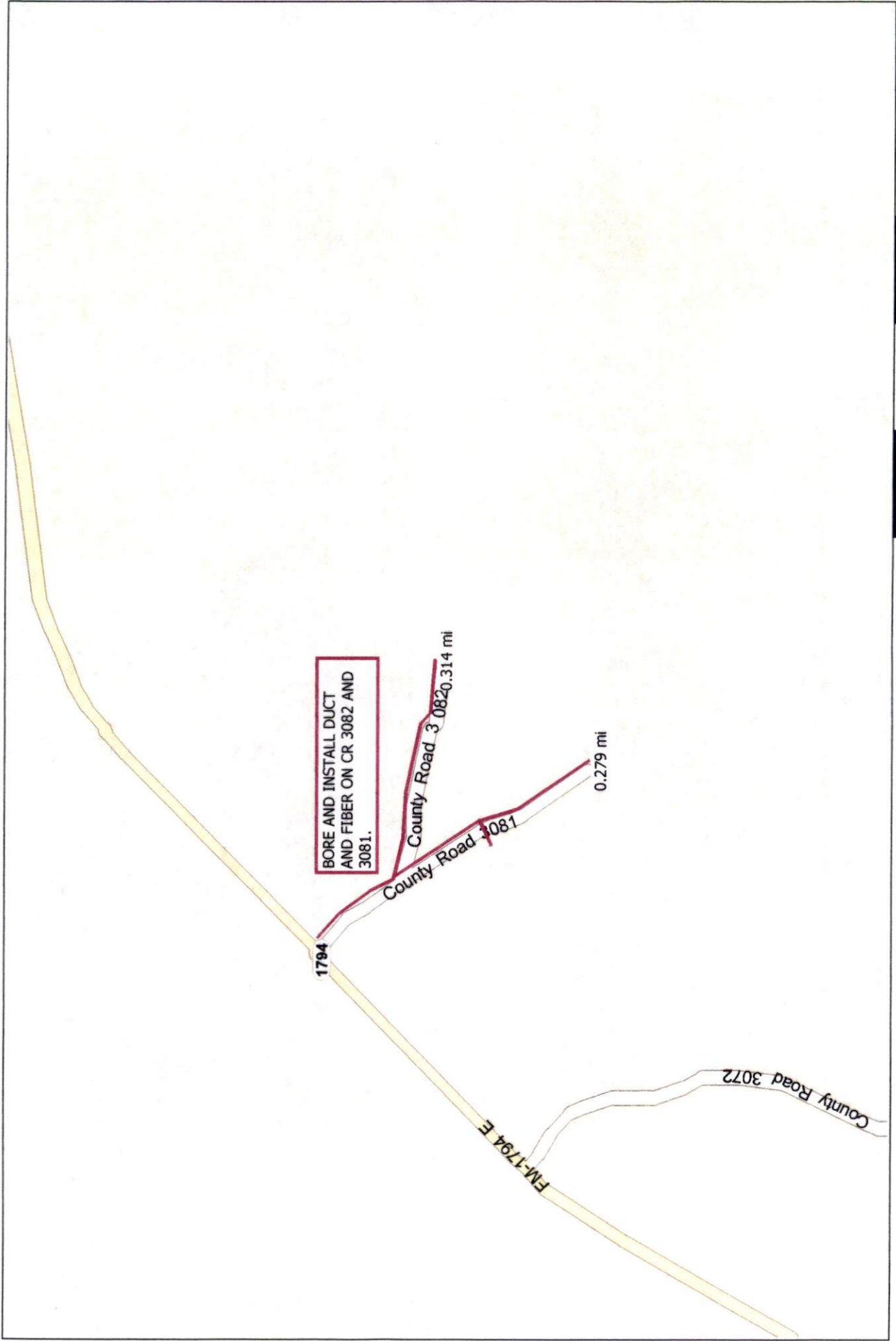

NOTICE OF PROPOSE INSTALLATION
PIPE AND / OR UTILITY LINES

DATE 7/16/18

TO : THE PANOLA COUNTY COMMISSIONERS COURT

c / o

PANOLA COUNTY ROAD & BRIDGE DEPARTMENT CARTHAGE TEXAS

Formal notice is hereby given that :

Eastex Telephone Co-op proposes to place a
(COMPANY NAME)

BORING INSTALL DUCT & FIBER line within the Right-of-way
(PIPE SIZE)

of County Road : CR 3082 as follows :
(NUMBER OF ROAD)

The proposed pipeline will cross under the indicated roads on the attached sheet.
Installation shall be made by boring total length of line in Panola County is 1,500'.

From the intersection of CR 3081 & CR 3082. Eastex will be boring and installing duct and fiber going southeast on north side of CR 3082 for approx. 1,500'.

The location and description of the proposed line and appurtenances is more full shown by the copies of drawings attached to this notice. The line will be constructed and maintained on the County Right-of-Way as directed by the County Commissioners in accordance with current Panola County Specifications.

Construction of this line will begin on or after the

16th day of JULY, 2018

FIRM : EASTEX TELEPHONE CO-OP

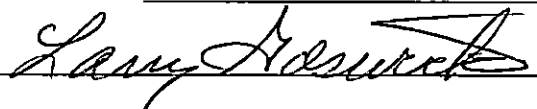
BY : 

TITLE : STAKING REPRESENTATIVE

ADDRESS : P. O. BOX 1691

WASKOM, TEXAS 75692

PHONE : (903) 687-3600

CR 3081 & 3082

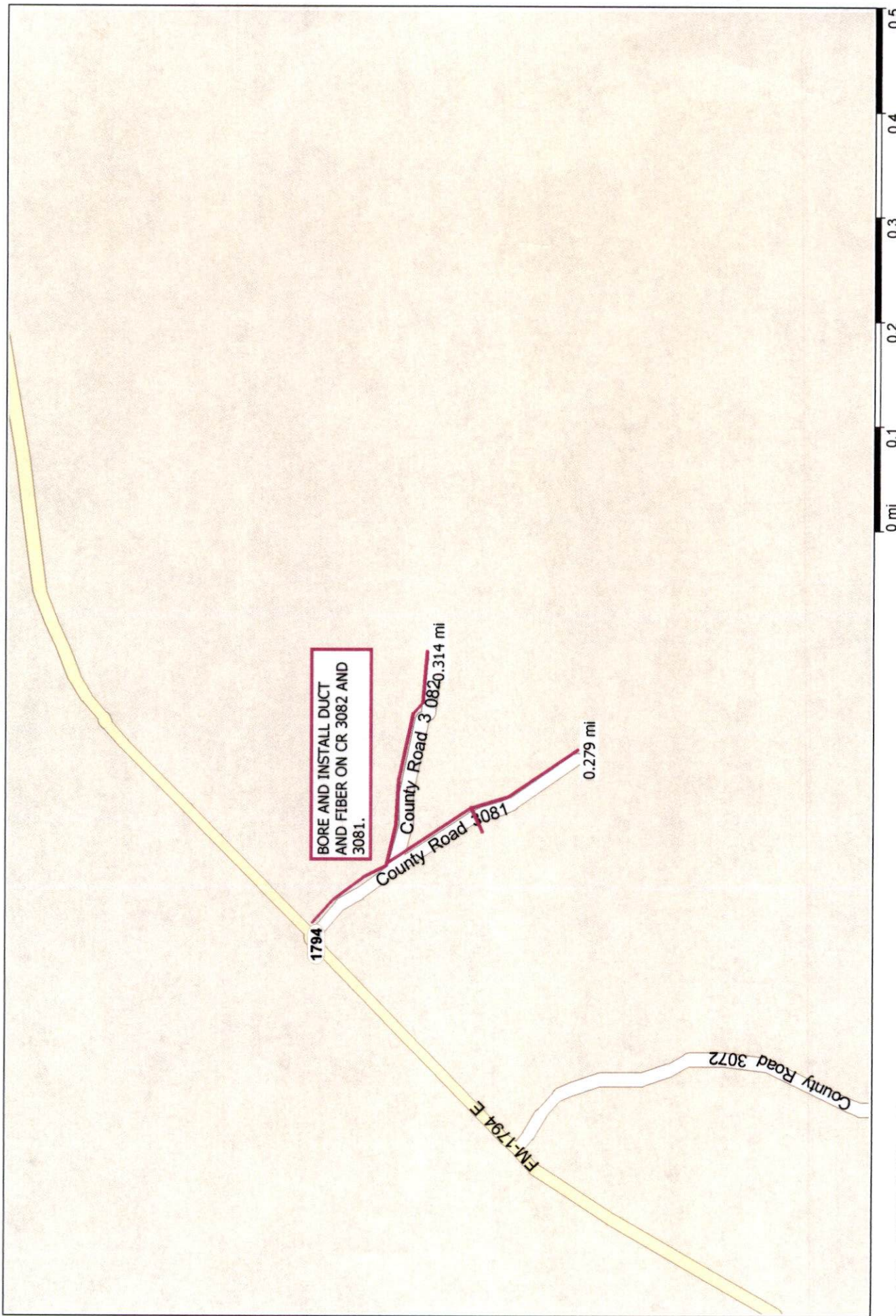

NOTICE OF PROPOSED INSTALLATION
PIPELINE AND/OR UTILITY LINES

TO: THE PANOLA COUNTY COMMISSIONER'S COURT

c/o

PANOLA COUNTY ROAD & BRIDGE DEPARTMENT, CARTHAGE, TEXAS

Formal notice is hereby given that:

Panola-Bethany Water Supply proposes to place a
(COMPANY NAME)

2" line within the Right-of-Way
(PIPE SIZE)

of County Road: 322 as follows:
(NUMBER OF ROAD)

The proposed pipeline will cross under the indicated roads on the attached sheet.
Installation shall be made by boring a total length of 70' line in Panola County.

The location and description of the proposed line and appurtenances is more fully shown by the copies of the drawings attached to this notice. The line will be constructed and maintained on the County Right-of-Way as directed by the County Commissioners in accordance with current Panola County Specifications.

Construction of this line will begin on or after the 26th day of
July, 2018.

FIRM: Panola-Bethany Water Supply
BY: James A. Thompson
TITLE: President
ADDRESS: PO Box 261
Panola, TX 75685
PHONE: (903) 692-0445

APPROVAL

July 24, 2018

TO: Panola-Bethany Water Supply
Attn: James A. Youngblood
P.O. Box 261
Panola, Texas 75685

RE: **CR #322**

The Panola County Commissioners' Court offers no objection to the location on the right-of-way of your proposed **2" line** within the right-of-way of County Roads **#322** as shown by accompanying drawings and notice except as noted below.

It is expressly understood that the County Commissioners' Court does not purpose hereby, to grant any right, claim, title or easement in or upon this county road. It is further understood that in the future should for any reason the county need to work, improve, relocate, widen, increase, add to, or in any manner change the structure of this right-of-way, any required relocation of said lines shall be at the sole expense of owner.

All work on the county right-of-way shall be performed in accordance with the county instructions. The installations shall not damage any part of the road and adequate provisions must be made to cause minimum inconvenience to traffic and adjacent owners. Special specifications for placing this line are as follows:

1. All lines are to be installed a minimum of 36 inches below the flow line of the adjacent drainage or barrow ditch.
2. All excavation within the right-of-way and not under surfacing shall be backfilled by tamping in 6 inch horizontal layers. All surplus material shall be removed from the right-of-way and the excavation finished flush with surrounding natural ground.
3. Lines crossing under surfaced roads and under surfacing cross roads within the right-of-way shall be placed by boring. Boring shall extend from crown line to crown line. Gravity from sewer lines under roadways shall be cast iron pipe.
4. All lines, where practicable, shall be located to cross roadbed at approximately right angles thereto. No lines are to be installed under or within 50 feet of either end of any bridge. No lines shall be placed in any culvert or within 10 feet of the closest point of same.
5. Parallel line will be installed as near the right-of-way lines as is possible and

no parallel line will be installed in the roadbed or between the drainage ditch and the roadbed without special permission of the Panola County Commissioners' Court.

6. Operations along roadbeds shall be performed in such manner that all excavated material be kept off the pavement at all times, as well as all operating equipment and materials. No equipment or installation procedures will be used which will damage any road surface or structures. The cost of any repairs to road surface, roadbed, structures or other right-of-way features as a direct result of this installation will be borne by the owner of this line.
7. Barricades, warning signs, lights, and flag man(men) when necessary shall be provided by the contractor or owner. One-half (1/2) of the traveled portion of the road must be open at all times.

Approved:  _____
COUNTY JUDGE

COMMISSIONERS:

Precinct #1	Ronnie LaGrone
Precinct #2	John Gradberg
Precinct #3	Craig M. Lawless
Precinct #4	Dale LaGrone

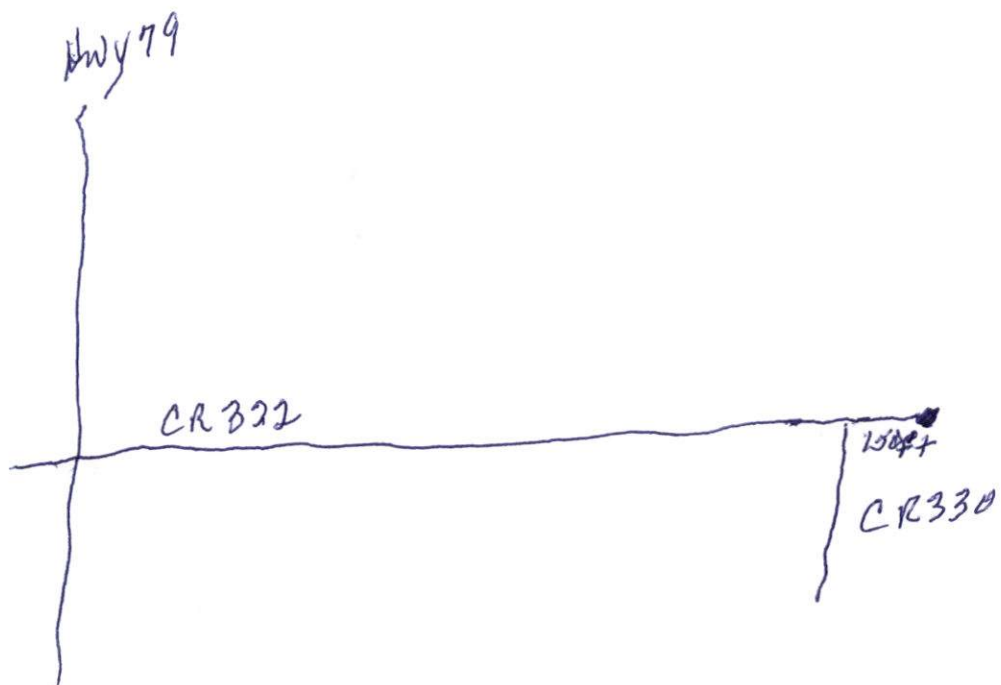

**NOTICE OF PROPOSED INSTALLATION
PIPELINE AND/OR UTILITY LINES**

TO: THE PANOLA COUNTY COMMISSIONER'S COURT

c/o

PANOLA COUNTY ROAD & BRIDGE DEPARTMENT, CARTHAGE, TEXAS

Formal notice is hereby given that:

CCI East Texas Upstream, LLC

_____ proposes to place a
(COMPANY NAME)

_____ 10" (ten inch) temporary _____ line within the Right-of-Way
(PIPE SIZE)

of County Road: _____ County Road 405 _____ as follows:
(NUMBER OF ROAD)

parallel with CR 405 on top of ground

The proposed pipeline will ~~cross under~~ the indicated roads on the attached sheet.
Installation shall be made by boring a total length of 1 mile _____ line in Panola County.

The location and description of the proposed line and appurtenances is more fully shown by the copies of the drawings attached to this notice. The line will be constructed and maintained on the County Right-of-Way as directed by the County Commissioners in accordance with current Panola County Specifications.

Construction of this line will begin on or after the _____ 10th _____ day of
_____ August _____, 2018.

FIRM: CCI East Texas Upstream, LLC
BY: _____
TITLE: _____
ADDRESS: 811 Main Street, Suite 1500
Houston, Texas
PHONE: () 281.378.1100

APPROVAL

July 24, 2018

TO: CCI East Texas Upstream, LLC
811 Main Street, Suite 1500
Houston, Texas

RE: **CR #405**

The Panola County Commissioners' Court offers no objection to the location on the right-of-way of your proposed **10" temporary line** within the right-of-way of County Road **#405** as shown by accompanying drawings and notice except as noted below.

It is expressly understood that the County Commissioners' Court does not purpose hereby, to grant any right, claim, title or easement in or upon this county road. It is further understood that in the future should for any reason the county need to work, improve, relocate, widen, increase, add to, or in any manner change the structure of this right-of-way, any required relocation of said lines shall be at the sole expense of owner.

All work on the county right-of-way shall be performed in accordance with the county instructions. The installations shall not damage any part of the road and adequate provisions must be made to cause minimum inconvenience to traffic and adjacent owners. Special specifications for placing this line are as follows:

1. All lines are to be installed a minimum of 36 inches below the flow line of the adjacent drainage or barrow ditch.
2. All excavation within the right-of-way and not under surfacing shall be backfilled by tamping in 6 inch horizontal layers. All surplus material shall be removed from the right-of-way and the excavation finished flush with surrounding natural ground.
3. Lines crossing under surfaced roads and under surfacing cross roads within the right-of-way shall be placed by boring. Boring shall extend from crown line to crown line. Gravity from sewer lines under roadways shall be cast iron pipe.
4. All lines, where practicable, shall be located to cross roadbed at approximately right angles thereto. No lines are to be installed under or within 50 feet of either end of any bridge. No lines shall be placed in any culvert or within 10 feet of the closest point of same.
5. Parallel line will be installed as near the right-of-way lines as is possible and

no parallel line will be installed in the roadbed or between the drainage ditch and the roadbed without special permission of the Panola County Commissioners' Court.

6. Operations along roadbeds shall be performed in such manner that all excavated material be kept off the pavement at all times, as well as all operating equipment and materials. No equipment or installation procedures will be used which will damage any road surface or structures. The cost of any repairs to road surface, roadbed, structures or other right-of-way features as a direct result of this installation will be borne by the owner of this line.
7. Barricades, warning signs, lights, and flag man(men) when necessary shall be provided by the contractor or owner. One-half (1/2) of the traveled portion of the road must be open at all times.

Approved: _____
COUNTY JUDGE

COMMISSIONERS:

Precinct #1	Ronnie LaGrone
Precinct #2	John Gradberg
Precinct #3	Craig M. Lawless
Precinct #4	Dale LaGrone

**SPECIAL SPECIFICATIONS
FOR PIPELINES CROSSING IN BORED HOLES
AND PLACED PARALLEL TO COUNTY ROADS**

GENERAL NOTE: The construction of this project shall follow "The Panola County Road and Bridge Department Standard Specifications" with respect to barricades, flagmen, flares, warning signs, and all responsibility for complaints or damage suits by traveling public and adjacent property owners.

1. Excavation material shall not be placed on road shoulders or traffic lanes or in ditches where drainage would be impaired. When excavation is permitted near the roadway, where, in the opinion of the County, the support of the road structure is endangered, sheeting, cribbing, other measures shall be taken to prevent damage to the roadway or the creation of traffic hazard.
2. All excavations shall be backfilled in a neat and workmanlike manner and all disturbed areas shall be restored to a condition comparable to the original condition. Backfill material shall be consolidated to a density comparable to that of the adjacent undisturbed material, replacing all of the excavated material except that displaced by pipe. The degree of compaction shall be such as to prevent future settlement. Excess material displaced by the pipe shall be removed from the right-of-way or otherwise disposed of to the satisfaction of the county's representative. Pipe laying operation shall not be carried on when soil conditions are such that construction equipment will cause rutting. Backfill operations shall be kept within one mile of trenching and/or pipe laying operations.
3. Sod and/or other erosion control measures removed or disturbed by the installation shall be replaced. This shall include keeping separate and replacing existing topsoil, importing sod or seeding or a combination of these methods together with fertilizer and water as necessary to re-establish vegetative cover in a healthy and growing condition.
4. The pipe or, if encased, the encasement pipe shall completely fit the bored hole and if not encased, the pipe should be a thicker wall within the bore; and shall be a minimum depth of 2 to 3 feet from the bottom of the ditch; and 3 to 4 feet underneath the roadway.
5. All private and commercial access driveways disturbed by pipe laying shall be restored to a condition comparable to that which existed prior to these operations. Special care shall be taken to compact backfill and base material to prevent future settlement. All work shall be complete to the owner's satisfaction. All public access driveways with paved surfaces shall be crossed by the bored hole method. Crossings of dirt or gravel public access driveways may be made as specified for private and commercial access driveways except that provisions shall be made for uninterrupted flow of traffic.
6. No trees or shrubbery shall be cut or trimmed without the approval of the Panola County Road and Bridge Department.

7. Regulations and ordinances of incorporated cities shall be compiled with, if within the City limits.

Commissioners:

Precinct #1 – Ronnie LaGrone
Precinct #2 –John W. Gradberg
Precinct #3 –Craig M. Lawless
Precinct #4 –Dale LaGrone



Google Earth

©2018 Google

Imagery Date: 4/6/2017 37°05'32.24" N 94°15'50.71" W elev 244 ft eye alt 6216 ft O

Tour Guide

NOTICE OF PROPOSED INSTALLATION
PIPELINE AND/OR UTILITY LINES

TO: THE PANOLA COUNTY COMMISSIONER'S COURT

c/o

PANOLA COUNTY ROAD & BRIDGE DEPARTMENT, CARTHAGE, TEXAS

Formal notice is hereby given that:

Rockcliff Energy, LLC proposes to place a
(COMPANY NAME)

12 inch Temporary above ground water line within the Right-of-Way
(PIPE SIZE)

of County Road: 466 as follows:
(NUMBER OF ROAD)

The proposed pipeline will ~~cross under the indicated roads on the attached sheet.~~ remain in west ditch as described on attached sheet.
Installation shall be made ~~by boring~~ by laying a total length of 1.4 miles line in Panola County.

The location and description of the proposed line and appurtenances is more fully shown by the copies of the drawings attached to this notice. The line will be ~~constructed~~ constructed and maintained on the County Right-of-Way as directed by the County Commissioners in accordance with current Panola County Specifications.

Laying
Construction of this line will begin on or after the 19th day of July 2018.

FIRM: Rockcliff Energy, LLC
BY: [Signature]
TITLE: Sr. P.O.W.
ADDRESS: 301 Vicksburg St.
Tyler TX 75703
PHONE: (936) 253-2752

APPROVAL

July 24, 2018

TO: Rockcliff Energy, LLC
301 Vicksburg St.
Tyler, Texas 75703

RE: **CR #466**

The Panola County Commissioners' Court offers no objection to the location on the right-of-way of your proposed **12" temporary above ground water line** within the right-of-way of County Road **#466** as shown by accompanying drawings and notice except as noted below.

It is expressly understood that the County Commissioners' Court does not purpose hereby, to grant any right, claim, title or easement in or upon this county road. It is further understood that in the future should for any reason the county need to work, improve, relocate, widen, increase, add to, or in any manner change the structure of this right-of-way, any required relocation of said lines shall be at the sole expense of owner.

All work on the county right-of-way shall be performed in accordance with the county instructions. The installations shall not damage any part of the road and adequate provisions must be made to cause minimum inconvenience to traffic and adjacent owners. Special specifications for placing this line are as follows:

1. All lines are to be installed a minimum of 36 inches below the flow line of the adjacent drainage or barrow ditch.
2. All excavation within the right-of-way and not under surfacing shall be backfilled by tamping in 6 inch horizontal layers. All surplus material shall be removed from the right-of-way and the excavation finished flush with surrounding natural ground.
3. Lines crossing under surfaced roads and under surfacing cross roads within the right-of-way shall be placed by boring. Boring shall extend from crown line to crown line. Gravity from sewer lines under roadways shall be cast iron pipe.
4. All lines, where practicable, shall be located to cross roadbed at approximately right angles thereto. No lines are to be installed under or within 50 feet of either end of any bridge. No lines shall be placed in any culvert or within 10 feet of the closest point of same.

5. Parallel line will be installed as near the right-of-way lines as is possible and no parallel line will be installed in the roadbed or between the drainage ditch and the roadbed without special permission of the Panola County Commissioners' Court.
6. Operations along roadbeds shall be performed in such manner that all excavated material be kept off the pavement at all times, as well as all operating equipment and materials. No equipment or installation procedures will be used which will damage any road surface or structures. The cost of any repairs to road surface, roadbed, structures or other right-of-way features as a direct result of this installation will be borne by the owner of this line.
7. Barricades, warning signs, lights, and flag man(men) when necessary shall be provided by the contractor or owner. One-half (1/2) of the traveled portion of the road must be open at all times.

Approved: 
COUNTY JUDGE

COMMISSIONERS:

Precinct #1	Ronnie LaGrone
Precinct #2	John Gradberg
Precinct #3	Craig M. Lawless
Precinct #4	Dale LaGrone

County Road Permit on State Line Road (CR 466) for Temporary Fresh Water Line, Panola County, TX

General Description of Requested Pipeline Route

This will be a temporary freshwater pipeline less than 13" in diameter used for the purposes of well fracturing. The Origin Source is a fresh water pond owned by Robert Sherman (Lat: 32°10'2.49"N, Long: 94° 3'1.69"W) located on FM 2517. The disposal source will be a much larger staging pond recently built on Mr. Pope's property at (Lat: 32° 8'36.56"N, Long: 94° 2'49.77"W). All landowners along the path of the county road have been contacted and will be compensated where required.

State Line Road (CR 466):

The Line will enter CR 466 west ditch from south side of FM 2517 at (Lat: 32°10'0.51"N, Long: 94° 2'33.85"W) and head due south along west side of road for 1.4 Miles before turning west off of the CR 466 right of way onto private property.

NO DRIVEWAYS OR ENTRANCES WILL BE BLOCKED – WE WILL USE DRIVEWAY CULVERTS THAT ARE LARGE ENOUGH OR LOW PROFILE CROSSINGS WHERE NECESSARY. ALL LANDOWNERS HAVE BEEN CONTACTED AND COMPENSATED WHERE/WHEN NECESSARY. THE ONLY CROSSINGS OF COUNTY ROADS WILL BE THROUGH CULVERTS WITH PLENTY OF ADDITIONAL ROOM FOR WATER TO FLOW.

Please see attached aerial maps. Please contact me anytime with questions or concerns.

Thank You,

Clint Smith,
Rockcliff Energy
(903) 253-2752 cell

Proposed Temp. Fresh Water Line

Write a description for your map.

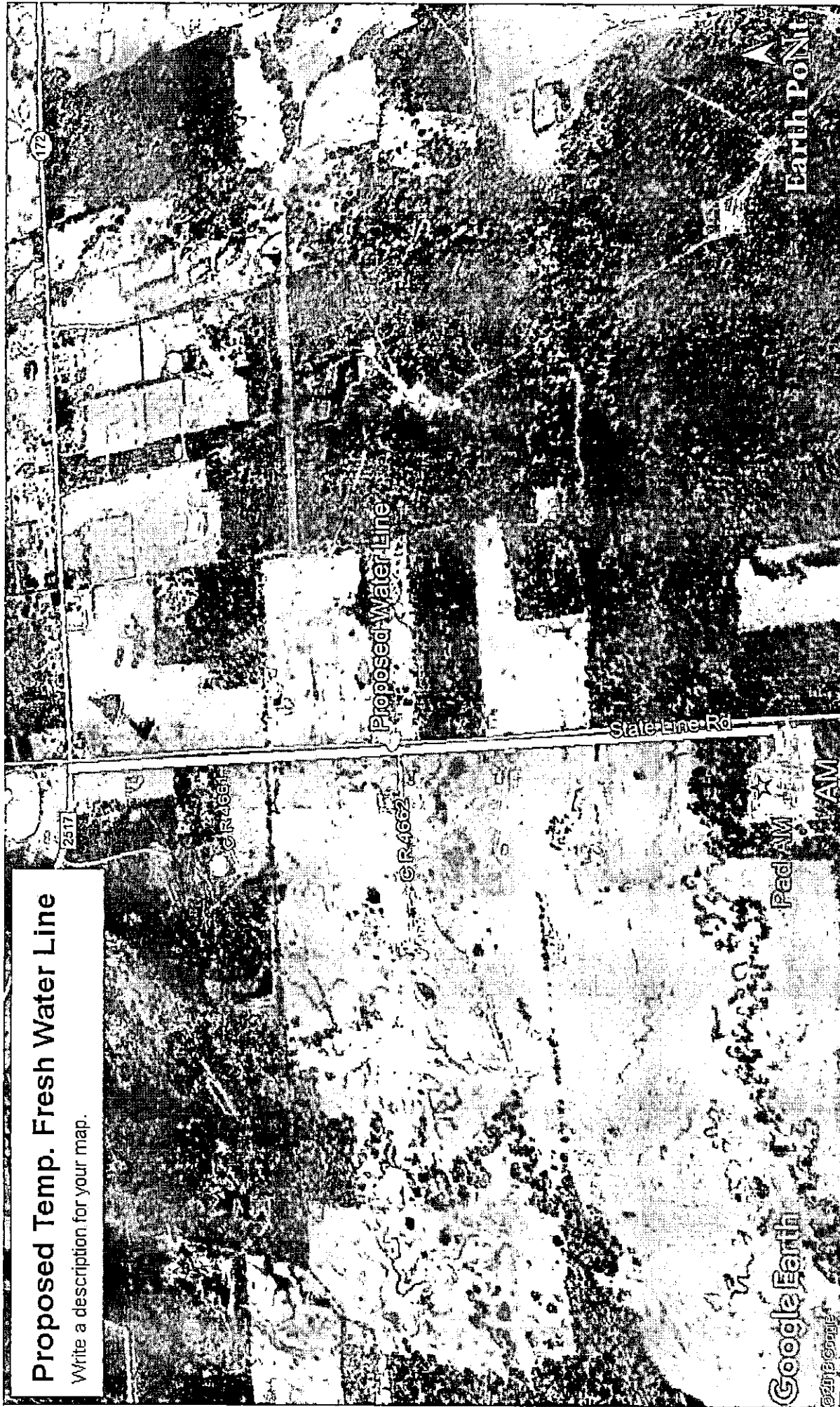



PANOLA COUNTY 2018 BUDGET AMENDMENT #14
July 24, 2018

ACCOUNT	ACCOUNT DESCRIPTION	AMOUNT	
GENERAL FUND			
REVENUES			
100-330-41130	STATE VOTER REGISTRATION	514	
100-340-45004	TAX ASSESSOR COLLECTOR	587	
			1,101
EXPENDITURES			
MISC. & NON-DEPARTMENTAL			
100-409-54080	CONTINGENCY	(4,210)	
100-409-54150	PROFESSIONAL SERVICES	2,785	
			(1,425)
ELECTIONS			
100-490-55270	FURNITURE & EQUIPMENT	514	
			514
AUDITOR			
100-495-54270	CONFERENCE & DUES	(2,000)	
100-495-55270	FURNITURE & EQUIPMENT	2,000	
			0
TAX ASSESSOR COLLECTOR			
100-499-55270	FURNITURE & EQUIPMENT	587	
			587
HEALTH & PAUPERS CARE			
100-646-54990	MISCELLANEOUS	1,425	
			1,425
GRAND TOTAL GENERAL FUND			1,101

ACCOUNT	ACCOUNT DESCRIPTION	AMOUNT	
ROAD & BRIDGE FUND			
REVENUES			
100-360-41020	MISCELLANEOUS REVENUES	53,239	
			53,239
EXPENDITURES			
PCT. 1			
200-621-55280	ROAD OIL PRE MIX & GRAVEL	21,054	
PCT.2			
200-622-53560	REPAIR AND MAINTENANCE SUPPLIES	28,485	
PCT. 3			
200-623-53570	PARTS & REPAIRS	3,700	
			53,239
GRAND TOTAL ROAD & BRIDGE FUND			53,239

**FM & LATERAL ROAD FUND
REVEUES**

300-360-41020	MISCELLANEOUS	103	
			103

EXPENDITURES

300-629-54080	CONTINGENCY	(1,500)	
300-629-54430	UTILITIES	103	
300-629-55270	FURNITURE & EQUIPMENT	1,500	
			103

GRANT TOTAL FM & LATERAL ROAD FUND

103

PANOLA COUNTY
2018
BUDGET AMENDMENT #14

We hereby amend the Panola County Budget for the Fiscal Year 2018 as set forth above according to the procedures outlined under Vernons Texas Codes Annotated Local Government Code, Chapter 111, Subchapter A Sections 111.010 (d), 111.0106, 111.0107, 111.0108. A copy of this Order is to be filed with the County Clerk and Attached to the Budget originally adopted for 2018.

Signed on this 24th day of July, 2018.

Lee Ann Jones
County Judge

Ronnie F. B.
Commissioner Precinct # 1

Absent
Commissioner Precinct # 2

C. J. M. G.
Commissioner Precinct # 3

Dale L. L.
Commissioner Precinct # 4

Passed and approved by the Commissioners Court of Panola County on the 24th day of July, 2018 as the same appears on file in the office of the County Clerk of Panola County.

Balukre Adams
County Clerk





PANOLA COUNTY JUVENILE PROBATION DEPARTMENT

315 West Panola Street • Carthage, Texas 75633
Telephone (903) 693-0352 • Fax (903) 693-0357

FILED FOR RECORD
IN MY OFFICE
AT 1:50 O'CLOCK P M

JUL 19 2018

BOBBIE DAVIS
COUNTY CLERK, PANOLA COUNTY, TEXAS
BY Ratich DEPUTY

Date: July 19, 2018

To: Panola County Commissioner's Court

From: Tracy Anderson, Chief Juvenile Probation Officer, Panola County

Subject: * FY '19 Proposed Budget for the Juvenile Probation Department

In accordance with section 140.004 of the Texas Local Government Code on this the 19th day of July, 2018, I hereby file the Fiscal Year 2019 proposed Budget for the Panola County Juvenile Probation Department with the Panola County Commissioner's Court.

Please be advised that a meeting of the Panola County Juvenile Board is scheduled for August 9th, 2018 at 9:30 AM in the County Court At Courtroom to consider and adopt the Fiscal Year 2019 proposed Budget for the Panola County Juvenile Probation Department .

Thank you for your consideration in this matter.

See attachments

Respectfully submitted

A handwritten signature in blue ink, appearing to read "Tracy Anderson", written over the typed name.

Tracy Anderson
Chief Juvenile Probation Officer

cc: Terry Bailey, Juvenile Board Chair
Sidney Burns, Panola County Auditor

FILED FOR RECORD
IN MY OFFICE
AT 1:51 O'CLOCK P M

PANOLA COUNTY JUVENILE PROBATION
FY2019 BUDGET
09/01/2018 - 08/31/2019

JUL 19 2018

BOBBIE DAVIS
COUNTY CLERK, PANOLA COUNTY, TEXAS
BY Roberts DEPUTY

INTERGOVERNMENTAL REVENUES

STATE AID GRANTS	190,403	184,575	184,195
GRANT R	8,928	16,230	8,000
LOCAL MATCH FUNDING	183,108	183,108	193,097

TOTAL INTERGOVERNMENTAL RECEIPTS	382,439	383,913	385,292
----------------------------------	---------	---------	---------

MISCELLANEOUS

PROBATION FEES	-	-	-
INTEREST EARNINGS	2,345	1,100	1,100
MISCELLANEOUS	-	-	-

TOTAL MISCELLANEOUS REVENUES	2,345	1,100	1,100
------------------------------	-------	-------	-------

TOTAL REVENUES	384,784	385,013	386,392
----------------	---------	---------	---------

CASH BALANCE FROM FUND 520 LOCALLY GENERATED REVENUE	-	-	-
--	---	---	---

CASH BALANCE FROM TITLE-IV E	-	25,000	25,000
------------------------------	---	--------	--------

CASH BALANCE FROM FUND 585 LOCAL MATCH	-	17,913	-
--	---	--------	---

	-	42,913	25,000
--	---	--------	--------

TOTAL REVENUES & RESOURCES AVAILABLE	384,784	427,926	411,392
--------------------------------------	---------	---------	---------

EXPENDITURES

ACTUAL

ESTIMATED

PROPOSED

9/1/2015
8/31/2016

9/1/2016
8/31/2017

09/01/2017
08/31/2018

STAFF SERVICES

SALARY & FRINGE BENEFITS

CHIEF PROBATION OFFICER	58,250	61,163	62,387
PROBATION OFFICERS	66,438	47,391	48,339
SOCIAL SECURITY	9,211	8,306	8,471
GROUP MEDICAL & LIFE INSURANCE	30,332	26,908	27,698
RETIREMENT & DEATH BENEFIT	29,899	26,022	26,575
WORKERS COMPENSATION	1,752	1,900	2,215
UNEMPLOYMENT INSURANCE	444	450	429
RETIREE GROUP MEDICAL	20,052	26,860	27,644
OTHER POST EMPLOYMENT BENEFITS	13,333	22,559	24,814

TOTAL STAFF SERVICES	229,711	221,559	228,572
----------------------	---------	---------	---------

TRAVEL & TRAINING	5,668	19,607	12,000
-------------------	-------	--------	--------

OPERATING EXPENSES	21,350	37,498	40,020
--------------------	--------	--------	--------

INTER-COUNTY CONTRACTS	45,209	91,000	86,500
------------------------	--------	--------	--------

EXTERNAL CONTRACTS	13,601	32,162	18,200
--------------------	--------	--------	--------

TITLE IV-E	-	25,000	25,000
------------	---	--------	--------

CAPITAL OUTLAY

FURNITURE, EQUIPMENT, AUTO	22,350	1,100	1,100
----------------------------	--------	-------	-------

TOTAL EXPENDITURES	337,889	427,926	411,392
--------------------	---------	---------	---------

IN MY OFFICE
AT 230 O'CLOCK P M

JUL 19 2018

2019 PANOLA COUNTY JUVENILE PROBATION PROPOSED BUDGET

BOBBIE DAVIS
COUNTY CLERK, PANOLA COUNTY, TEXAS
By Robert DEPUTY

	BASIC PROBATION	COMMUNITY PROGRAMS	PRE & POST ADJUDICATION	COMMITMENT DIVERSION	MENTAL HEALTH SERVICES	REGIONAL DIVERSION ALTERNATIVES PROGRAM	LOCAL FUNDING	LOCALLY GENERATED REVENUES	TITLE IV-E	TOTALS
STATE FUNDING	\$ 53,263	\$ 54,932	\$ 60,000	\$ 7,000	\$ 9,000	\$ 8,000				
LOCAL MATCH FUNDING							\$ 193,097			
PROB FEES & INTEREST EARNING & MISC.								\$ 1,100		
CASH BALANCE USED									\$ 25,000	
TOTALS	\$ 53,263	\$ 54,932	\$ 60,000	\$ 7,000	\$ 9,000	\$ 8,000	\$ 193,097	\$ 1,100	\$ 25,000	\$ 411,392

EXPENDITURES

COURT INTAKE	\$ 45,932									
Salary & Fringe	\$ 45,932									\$ 45,932
Travel & Training										
Operating Expenses										
Inter-County Contracts										
External Contracts										

DIRECT SUPERVISION	\$ 44,643						\$ 170,397			
Salary & Fringe	\$ 31,243						\$ 151,397			\$ 182,640
Travel & Training	\$ 8,000						\$ 4,000			\$ 12,000
Operating Expenses	\$ 5,400						\$ 15,000			\$ 20,400
Inter-County Contracts										
External Contracts										

MENTAL HEALTH ASSESSMENTS	\$ 8,620				\$ 9,000	\$ 2,000				
Salary & Fringe										
Travel & Training										
Operating Expenses	\$ 8,620				\$ 9,000	\$ 2,000				\$ 19,620
Inter-County Contracts										
External Contracts										

COMM.-BASED PROGRAMS-GENERAL	\$ 9,000					\$ 6,000	\$ 3,200			
Salary & Fringe										
Travel & Training										
Operating Expenses										
Inter-County Contracts										
External Contracts	\$ 9,000					\$ 6,000	\$ 3,200			\$ 18,200

POST-ADJ.(SECURE)	\$ 30,000			\$ 7,000			\$ 9,000		\$ 12,500	
Salary & Fringe										
Travel & Training										
Operating Expenses										
Inter-County Contracts	\$ 30,000			\$ 7,000			\$ 9,000		\$ 12,500	\$ 58,500
External Contracts										

POST-ADJ.(NON-SECURE)							\$ 5,500		\$ 12,500	
Salary & Fringe										
Travel & Training										
Operating Expenses										
Inter-County Contracts							\$ 5,500		\$ 12,500	\$ 18,000
External Contracts										

DETENTION/PRE. ADJ.	\$ 30,000						\$ 5,000			
Salary & Fringe										
Travel & Training										
Operating Expenses										
Inter-County Contracts	\$ 30,000						\$ 5,000			\$ 35,000
External Contracts										

CAPITAL OUTLAY								\$ 1,100		\$ 1,100
----------------	--	--	--	--	--	--	--	----------	--	----------

TOTALS	\$ 53,263	\$ 54,932	\$ 60,000	\$ 7,000	\$ 9,000	\$ 8,000	\$ 193,097	\$ 1,100	\$ 25,000	\$ 411,392
--------	-----------	-----------	-----------	----------	----------	----------	------------	----------	-----------	------------

APPROVED

07-24-2018

AG

Lee Ann Jones,
County Judge

PANOLA COUNTY OFFICIAL/EMPLOYEE
REQUEST FOR ATTENDANCE AT A CONFERENCE

NAME:

Travis Curry

POSITION:

Deputy

DEPARTMENT:

Panola County Sheriff's Office

DATE:

7-6-18

CONFERENCE:

Special Investigative Topics

LOCATION:

Panola Co. S.O.

DATES:

8-7-18

to

8-7-18

NUMBER OF DAYS OUT OF OFFICE FOR THIS CONFERENCE:

1

Does the conference meet your educational requirements for the year?

No

If not, how much of your requirements will be met by this conference?

8

How much of your requirements have been met already, not counting this conference?

22

How many days have you been away from your job this year for conferences, not counting this conference?

2

Do you have sufficient funds in your budget for this conference?

Yes

Write a short statement explaining the public purpose that will be met by your attendance at this conference: (continue on the back if necessary.)

Required training

APPROVED

07-24-2018



Lee Ann Jones,
County Judge

PANOLA COUNTY OFFICIAL/EMPLOYEE
REQUEST FOR ATTENDANCE AT A CONFERENCE

NAME:

Chris Dickerson

POSITION:

Deputy

DEPARTMENT:

Panola County Sheriff's Office

DATE:

7-6-18

CONFERENCE:

Special Investigative Topics

LOCATION:

Panola Co. S.O.

DATES:

8-7-18

to

8-7-18

NUMBER OF DAYS OUT OF OFFICE FOR THIS CONFERENCE:

1

Does the conference meet your educational requirements for the year?

No

If not, how much of your requirements will be met by this conference?

8

How much of your requirements have been met already, not counting this conference?

22

How many days have you been away from your job this year for conferences, not counting this conference?

2

Do you have sufficient funds in your budget for this conference?

Yes

Write a short statement explaining the public purpose that will be met by your attendance at this conference: (continue on the back if necessary.)

Required training

APPROVED

07-24-2018

[Signature]

Lee Ann Jones,
County Judge

PANOLA COUNTY OFFICIAL/EMPLOYEE
REQUEST FOR ATTENDANCE AT A CONFERENCE

NAME:

Calahan Malone

POSITION:

Deputy

DEPARTMENT:

Panola County Sheriff's Office

DATE:

7-6-18

CONFERENCE:

Special Investigative Topics

LOCATION:

Panola Co. S.O.

DATES:

8-9-18

to

8-9-18

NUMBER OF DAYS OUT OF OFFICE FOR THIS CONFERENCE:

1

Does the conference meet your educational requirements for the year?

No

If not, how much of your requirements will be met by this conference?

8

How much of your requirements have been met already, not counting this conference?

22

How many days have you been away from your job this year for conferences, not counting this conference?

2

Do you have sufficient funds in your budget for this conference?

Yes

Write a short statement explaining the public purpose that will be met by your attendance at this conference: (continue on the back if necessary.)

Required training

APPROVED

07-24-2018



Lee Ann Jones,
County Judge

PANOLA COUNTY OFFICIAL/EMPLOYEE
REQUEST FOR ATTENDANCE AT A CONFERENCE

NAME:

Richard Mojica

POSITION:

Deputy

DEPARTMENT:

Panola County Sheriff's Office

DATE:

7-6-18

CONFERENCE:

Special Investigative Topics

LOCATION:

Panola Co. S.O.

DATES:

8-9-18

to

8-9-18

NUMBER OF DAYS OUT OF OFFICE FOR THIS CONFERENCE:

1

Does the conference meet your educational requirements for the year?

No

If not, how much of your requirements will be met by this conference?

8

How much of your requirements have been met already, not counting this conference?

22

How many days have you been away from your job this year for conferences, not counting this conference?

2

Do you have sufficient funds in your budget for this conference?

Yes

Write a short statement explaining the public purpose that will be met by your attendance at this conference: (continue on the back if necessary.)

Required training

APPROVED

07-24-2018



Lee Ann Jones,
County Judge

PANOLA COUNTY OFFICIAL/EMPLOYEE
REQUEST FOR ATTENDANCE AT A CONFERENCE

NAME:

Jeremy Nagle

POSITION:

Deputy

DEPARTMENT:

Panola County Sheriff's Office

DATE:

7-6-18

CONFERENCE:

Special Investigative Topics

LOCATION:

Panola Co. S.O.

DATES:

8-7-18

to

8-7-18

NUMBER OF DAYS OUT OF OFFICE FOR THIS CONFERENCE: 1

Does the conference meet your educational requirements for the year? No

If not, how much of your requirements will be met by this conference? 8

How much of your requirements have been met already, not counting this conference?

22

How many days have you been away from your job this year for conferences, not counting this conference? 2

Do you have sufficient funds in your budget for this conference? Yes

Write a short statement explaining the public purpose that will be met by your attendance at this conference: (continue on the back if necessary.)

Required training

APPROVED

07-24-2018

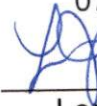

Lee Ann Jones,
County Judge

PANOLA COUNTY OFFICIAL/EMPLOYEE
REQUEST FOR ATTENDANCE AT A CONFERENCE

NAME:

Josh Nagle

POSITION:

Deputy

DEPARTMENT:

Panola County Sheriff's Office

DATE:

7-6-18

CONFERENCE:

Special Investigative Topics

LOCATION:

Panola Co. S.O.

DATES:

8-9-18

to

8-9-18

NUMBER OF DAYS OUT OF OFFICE FOR THIS CONFERENCE:

1

Does the conference meet your educational requirements for the year?

No

If not, how much of your requirements will be met by this conference?

8

How much of your requirements have been met already, not counting this conference?

22

How many days have you been away from your job this year for conferences, not counting this conference?

2

Do you have sufficient funds in your budget for this conference?

yes

Write a short statement explaining the public purpose that will be met by your attendance at this conference: (continue on the back if necessary.)

Required training

APPROVED

07-24-2018



Lee Ann Jones,
County Judge

PANOLA COUNTY OFFICIAL/EMPLOYEE
REQUEST FOR ATTENDANCE AT A CONFERENCE

NAME:

Timothy Windham

POSITION:

Deputy

DEPARTMENT:

Panola County Sheriff's Office

DATE:

7-6-18

CONFERENCE:

Special Investigative Topics

LOCATION:

Panola Co. S.O.

DATES:

8-7-18

to

8-7-18

NUMBER OF DAYS OUT OF OFFICE FOR THIS CONFERENCE: 1

Does the conference meet your educational requirements for the year? No

If not, how much of your requirements will be met by this conference? 8

How much of your requirements have been met already, not counting this conference?

22

How many days have you been away from your job this year for conferences, not counting this conference? 2

Do you have sufficient funds in your budget for this conference? Yes

Write a short statement explaining the public purpose that will be met by your attendance at this conference: (continue on the back if necessary.)

Required training

PANOLA COUNTY OFFICIAL/EMPLOYEE
REQUEST FOR ATTENDANCE
AT A CONFERENCE

APPROVED

07-24-2018

Lee Ann Jones,
County Judge

NAME:

Charles Blue

POSITION:

Deputy Constable

DEPARTMENT:

Constable Pct. 2 & 3

DATE:

7-11-18

CONFERENCE:

Courtroom Security Officer Training

LOCATION:

PCSO

DATES:

7-12-18

to

7-12-18

NUMBER OF DAYS OUT OF OFFICE FOR THIS CONFERENCE: 1

Does the conference meet your educational requirements for the year? No

If not, how much of your requirements will be met by this conference? 8 hrs

How much of your requirements have been met already, not counting this conference?

How many days have you been away from your job this year for conferences, not counting this conference?

Do you have sufficient funds in your budget for this conference? Yes (\$26.00) school

Write a short statement explaining the public purpose that will be met by your attendance at this conference: (continue on the back if necessary.)

Required class for bailiffs.

PANOLA COUNTY OFFICIAL/EMPLOYEE
REQUEST FOR ATTENDANCE
AT A CONFERENCE

APPROVED

07-24-2018



Lee Ann Jones,
County Judge

Danny Buck Davidson

NAME: 2018 Annual Criminal & Civil Law Update

POSITION: Panola County Criminal District

DEPARTMENT: Same

DATE: 9/19/18 to 9/21/18

CONFERENCE: Annual Conference for 2018

LOCATION: Galveston

DATES: 9/19/18 to 9/21/18

NUMBER OF DAYS OUT OF OFFICE FOR THIS CONFERENCE: 5

Does the conference meet your educational requirements for the year? almost

If not, how much of your requirements will be met by this conference? 12 hrs CLE +

3 hours of Ethics

How much of your requirements have been met already, not counting this

conference? a small amount

How many days have you been away from your job this year for conferences, not

counting this conference? may a half day

Do you have sufficient funds in your budget for this conference? yes

Write a short statement explaining the public purpose that will be met by your attendance at this conference: (continue on the back if necessary.)

The annual conference allow attendees to meet & discuss various problem each officer has. Working together allows each officer to act together for the common good. Being schooled on the most applicable law keep our officer updated and on top of the newly elected law makes.

KATIE NIELSEN
Assistant District Attorney

KEVIN JONES
Criminal Investigator



123rd JUDICIAL DISTRICT
PANOLA COUNTY, TEXAS

COUNTY COURT AT LAW
PANOLA COUNTY, TEXAS

DANNY BUCK DAVIDSON
Criminal District Attorney

July 16, 2018

Panola County Commissioner's Court

Dear Judge & Commissioners:

This letter is to request that I be approved for attendance to the 2018 Annual Criminal & Civil Law Update in Galveston, Texas, September 19 thru 21, 2018.

This meeting should help in meeting my CLE hours.

Sincerely,

A handwritten signature in blue ink, which appears to read "Danny Buck Davidson", is written over the printed name.

Danny Buck Davidson

DBD:je